

N4DCL

**4 DIAL
MECHANICAL
COMBINATION
LOCK**



N4DCL

Mechanical Combination Lock



FEATURES

- Full Metal Lock Body
- Master Key Over-Ride
- Retrieve forgotten code

TECHNICAL DRAWING

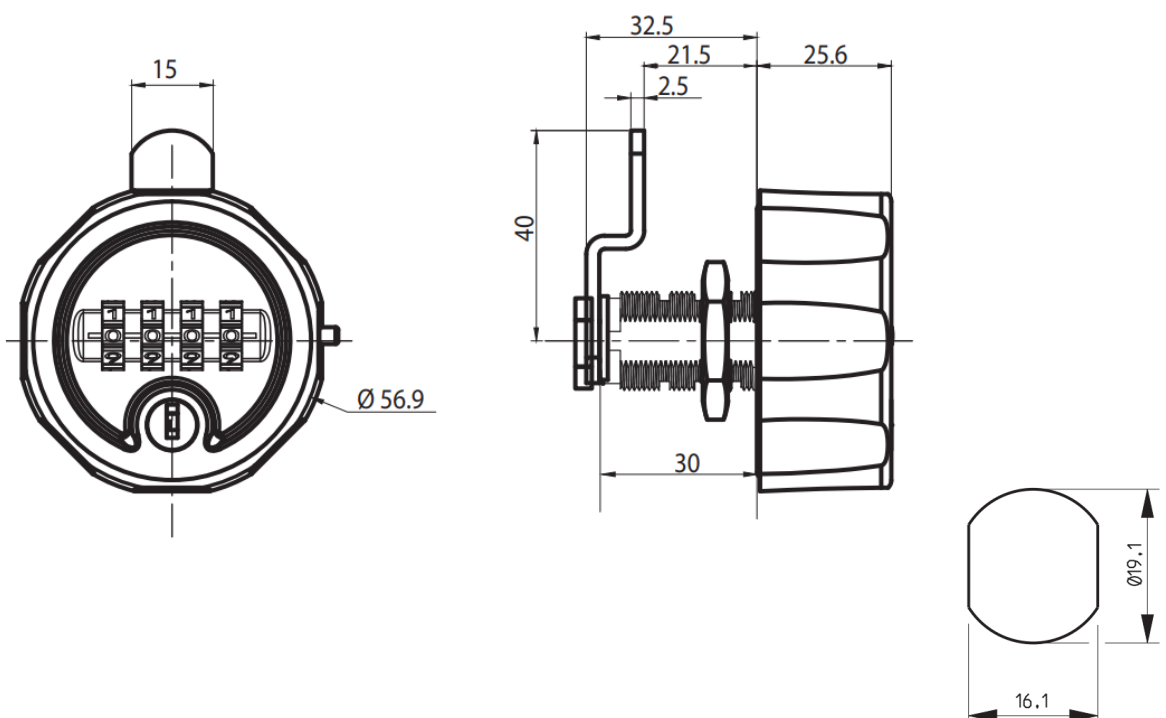

N4DCL

Mechanical Combination Lock

User Instructions

Setting a New Code

The default factory code is 0000. To change this, first ensure the dials are correct. Press and hold the code settings button

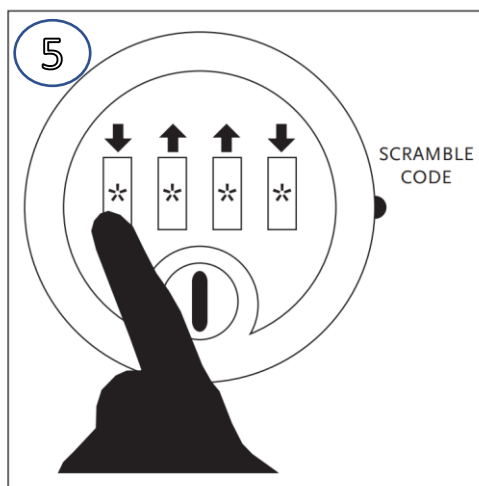
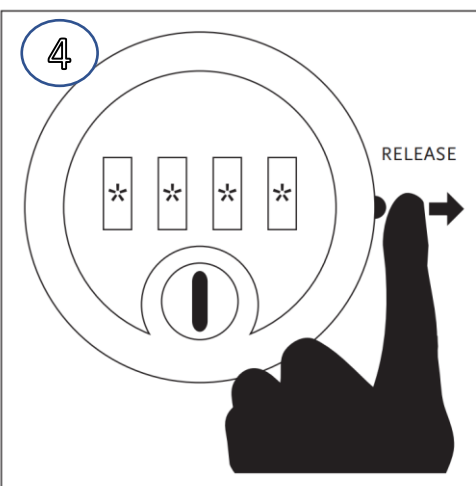
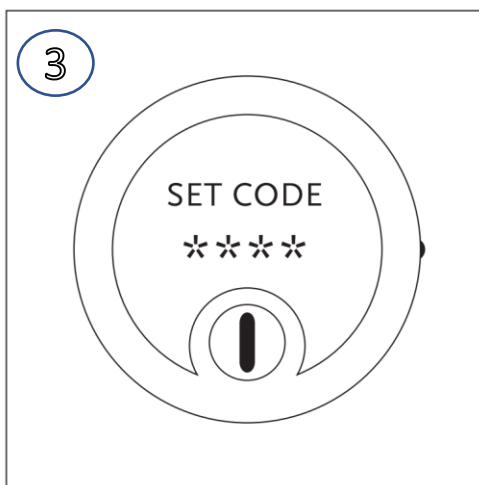
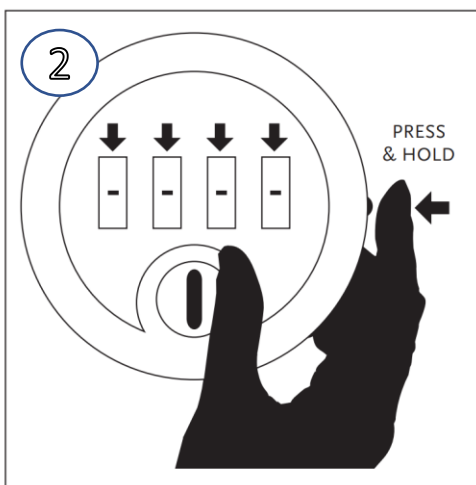
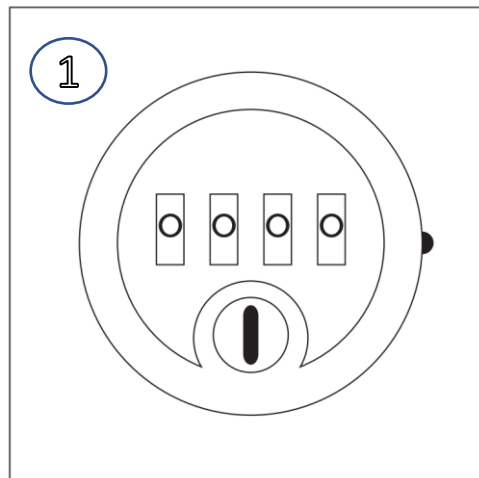

MK718

Mechanical Combination Lock

Recovering Lost / Forgotten Code

Using the
Reset / Master Key

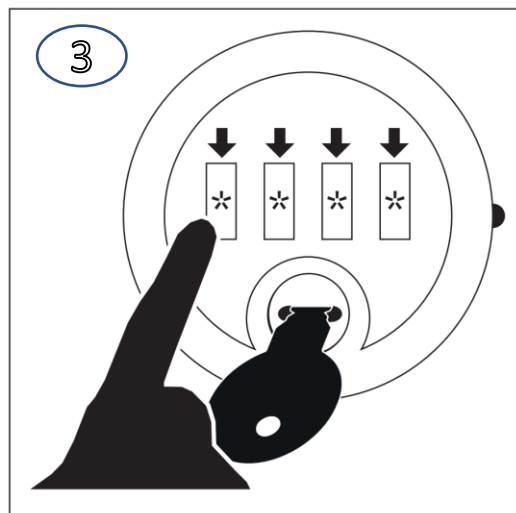
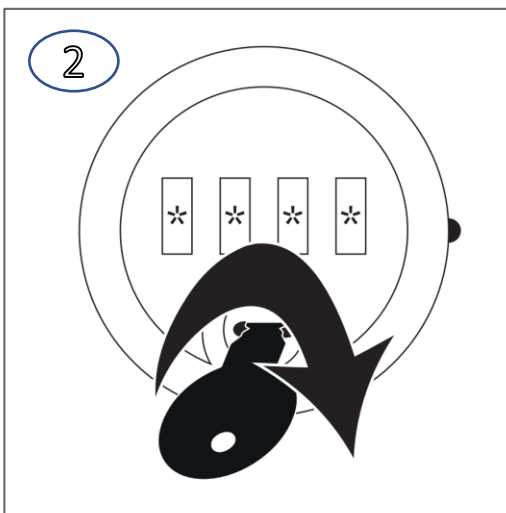
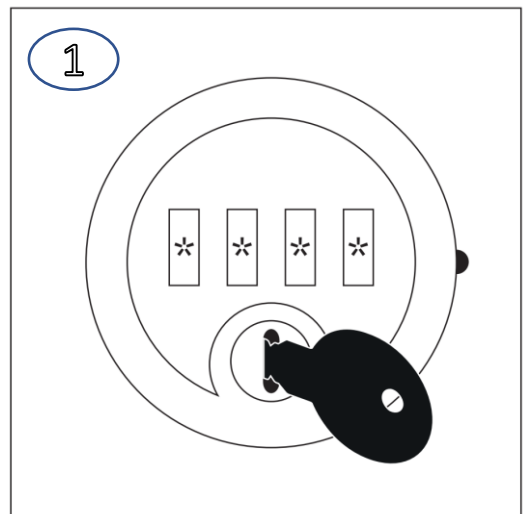

Turn each digit until it stops.

Once all 4 dials are turned into position, your forgotten code is revealed



QI LOCKS LIMITED

Unit 14

Stephenson Court

Priory Business Park

Bedford

MK44 3WJ



0330 311 1003



sales@qilocks.com



www.qilocks.com

